

# OPERATING MANUAL

## Aurora A400- Basic

Important: Please read the instruction manual carefully prior to installation and keep it for future reference.

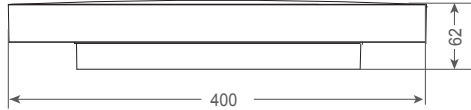

Ordering code	Product	Power (W)	Function Description
	Fitting series		
A400 18 000	A400	18	Basic LED

Mounting: Wall or Ceiling

Light brief features:

Ra: >80



Life Time: 5 years

Light Source: LED SMD2835

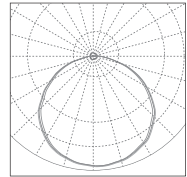
Input: 220V-240V 50/60Hz



### Accessories

No.	Pic.	Qty.	Usage
1		3	Fix light
2		3	Rawl plug
3		1	Rubber plug

### Color temperature code:

Code	Color temperature	CCT(K)	Lumen
30K	Warm White	3000	1940
40K	Natural White	4000	1980
50K	Cool White	5000	2005

### Installation

#### Ceiling light open

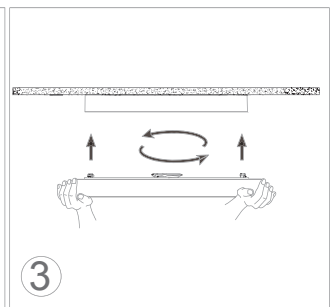
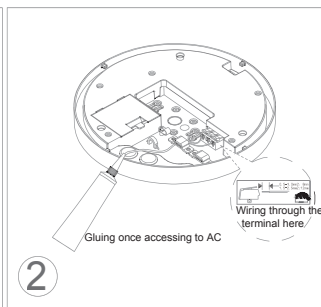
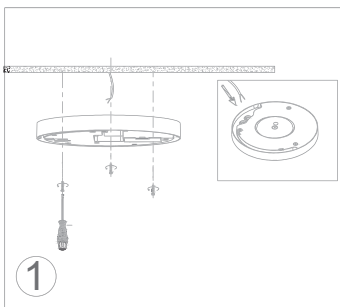
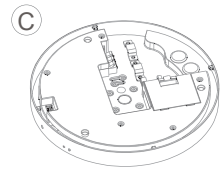
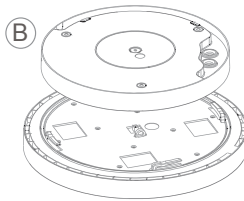
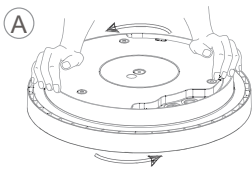

## Maintenance

1. Cut off the main power first
2. Don't touch LED while maintaining or cleaning
3. Don't use chemical reagent to clean lamp.

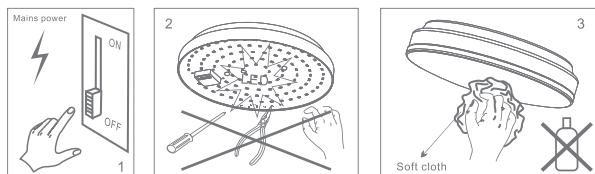

Environmental protection: waste electrical products should not be disposed of with household waste. Please recycle where facilities exist. Check with your local authority or retailer for recycling advice. 

## Caution:

1. The product must be installed by professional technicians and power supply must be cut off before installation.
2. The diameter for AC input wire is 0.75mm<sup>2</sup> (complying with 60245 IEC57), which complies with the latest IEE electrical standards or national standards.
3. Do not touch the electronic circuit and its components.
4. Contact an authorised technical service centre for any repairs possibly required use only original spare parts.
5. Do not touch LED while installing or maintaining.
6. Sealing the entrance hole with glue after install is needed.
7. The light source contained in this luminaire shall only be replaced by the manufacturer or his service agent or a similar qualified person.



SAA



IP54

IK10



5 year warranty